

2tec2[®]
high tech flooring



Refined woven flooring

BREEAM[®] Building Certification
International new construction ^(V6)





Defining responsible flooring

BREEAM® BUILDING CERTIFICATION

Since 1990, the BREEAM® (British Research Establishment Environmental Assessment Method) certification system has been stimulating the construction sector to become more sustainable by assigning certain scores to buildings.

Efforts, choices and performances that improve sustainability during the construction process are factored into this certification. As a building product, 2TEC2 can make a significant contribution to a building's sustainability score.



06 — Health
& wellbeing

Responsible &
sustainable building — 08

10 — Energy
efficiency

Components with — 12
a long life expectancy

14 — Waste
management

Product
cross-section — 17

Score overview

The BREEAM® certification method assesses a project on 9 categories, each consisting of different items. **2TEC2** contributes to **12 items** in **5 categories**, yielding up to **16 credits**.



CATEGORY		ITEM	MAX CREDITS
Health & wellbeing	HEA 01	Visual comfort	Up to 1 credit
	HEA 02	Indoor air quality	Up to 3 credits
	HEA 04	Thermal comfort	Up to 1 credit
	HEA 05	Acoustic performance	Up to 2 credits
Management	MAN 02	Life cycle cost and service life planning	Up to 1 credit
	MAN 04	Commissioning & handover	Up to 1 credit
Energy	ENE 04	Low carbon design	Up to 2 credits
Materials	MAT 01	Life cycle impacts	Up to 1 credit
	MAT 05	Designing for durability and resilience	Up to 1 credit
Waste	WST 01	Construction waste management	Up to 1 credit
	WST 04	Speculative finishes	Up to 1 credit
	WST 06	Functional adaptability	Up to 1 credit



Health and wellbeing of residents and visitors

A building should enhance the well-being and comfort of its users and visitors. Building products such as 2TEC2 can contribute to creating a healthy and safe environment.

VISUAL COMFORT

→ HEA.01

Ensuring visual comfort is of extraordinary importance to us. We consider it essential that this is taken into account in the design phase of each project. Spaces with different colours and types of lighting, both natural and artificial, require different flooring solutions. To make the right choice, we offer a brochure listing the LRVs (Light Reflectance Values) of all our references. This enables glare control. In addition, excess energy consumption for lighting is avoided.

Our score:

Up to 1 credit Glare control

INDOOR AIR QUALITY

→ HEA.02

2TEC2 contributes to a healthy indoor environment and has the certificates and ecolabels to prove it. Our products comply with the permissible emission of VOCs (Volatile Organic Compounds) and are 100% safe for indoor use. All our certificates and labels, on national, European, and American levels, can be found on our technical sheet. For example, 2TEC2 achieved the Indoor Air Comfort® Gold, Floorscore® and M1 certifications.

The woven structure of our top layer captures fine dust particles, preventing them from floating around in the air. These particles can then be 100% removed during cleaning, which is not the case with tufted carpet tiles.

Our score:

Up to 1 credit Reduced air pollution

Up to 2 credits Exemplary level

THERMAL COMFORT

→ HEA.04

2TEC2 is perfectly compatible with floor heating systems. Even when underfloor heating is not used, our SonoFelt™ backing creates an insulating buffer between the cold subfloor and the comfortable room temperature.

Our score:

Up to 1 credit Thermal modelling

ACOUSTIC PERFORMANCE

→ HEA.05

2TEC2's excellent acoustic properties make a room and its adjacent rooms much more pleasant. The impact sound reduction of our floors is 19 dB. The values of sound absorption and walking noise reduction can also be found on our technical sheet.

Our score:

Up to 1 credit Indoor sound reduction

Up to 1 credit Reverberation times

Making responsible choices during the development of a building can make a big difference in terms of sustainability. 2TEC2 applies sustainable management throughout the entire life cycle of the floor covering, from design to commissioning and maintenance.

LIFE CYCLE COST AND SERVICE LIFE PLANNING

→ MAN.02

The Environmental Product Declaration (EPD) presents the results of the life cycle assessment (LCA). Based on the EPD, a Life Cycle Cost (LCC) analysis can be developed. The EPDs of all 2TEC2 products are up-to-date. We offer manuals and videos for installation and maintenance and are always ready to provide personal technical support.

Our score:

Up to 1 credit LCC component appraisal

COMMISSIONING & HANDOVER

→ MAN.04

The durability of a product relies on proper use and maintenance. To maximise the lifespan of our floors, we keep our maintenance manuals up-to-date and easily accessible. Test reports can be viewed on request. If needed, we are always available for questions and support.

Our score:

Up to 1 credit Handover



Responsible & sustainable choices during a building's development phase



Energy efficiency



Energy is a 'hot topic' and of great importance in both new construction projects and renovations. 2TEC2 can reduce a building's energy consumption and associated CO₂ emissions.

LOW CARBON DESIGN

→ ENE.04

Insulation capacities and thermal resistance are the keys to success when it comes to reducing daily energy usage. Our recycled non-woven felt backing has an insulating effect by preventing direct contact between your cold subfloor and interior space. This, in turn, lowers the energy consumption needed to heat the area.

Our score:

Up to 2 credits Passive design

Limited components with a long lifespan

12

A responsible choice of materials means a lower environmental impact. Opting for materials with a long life cycle reduces the amount of raw materials needed, resulting in a more sustainable building.

The design, construction, maintenance, and repair of a product all play a role in this.

A photograph showing a close-up of a Carrara marble floor. The marble has a light beige base with intricate, swirling patterns of grey and white. A solid black rectangular object is placed on the floor, casting a soft shadow. The background is a plain, light-colored wall.

Marble Carrara



LIFE CYCLE IMPACTS

→ MAT.01

For all 2TEC2 products, a 'cradle to grave' life cycle analysis (LCA) has been calculated, which is presented in an EPD (Environmental Product Declaration). This document gives an idea of the environmental impact of 2TEC2 and enables contractors to compare with other products. It allows them to responsibly choose the product that gives their building the lowest environmental impact possible.

Our score:

Up to 1 credit Environmental Product Declaration

DESIGNING FOR DURABILITY AND RESILIENCE

→ MAT.05

2TEC2 looks like textile, but performs like hard flooring. Our unique hybrid flooring combines the qualities of a traditional flat-weave product to that of a hard flooring solution. With class 33, 2TEC2 attains the highest possible level of durability and wear resistance. A floor with a long life span minimises the frequency of replacement and maximises the optimisation of materials.

Our score:

Up to 1 credit Protecting vulnerable parts of the building from damage

Less is definitely more when it comes to waste. 2TEC2 is committed to the proper management and recycling of construction and industrial waste.

CONSTRUCTION WASTE MANAGEMENT

→ WST.01

2TEC2 encourages proper waste management and assists its customers throughout this entire process. We help calculate the right number of required tiles, avoiding surpluses and therefore waste. In addition, we have already convinced 80% of our customers to choose tiles instead of rolls, creating 50% less cutting waste. We also avoid unnecessary packaging waste. The packaging we do use, consists of recycled cardboard that can be reprocessed afterwards.

Our score:

Up to 1 credit Reduction of construction waste

FUNCTIONAL ADAPTABILITY

→ WST.06

2TEC2 tiles are installed with a non-permanent adhesive, making it easy to replace or relocate individual tiles. This provides quick and easy access to technical installations beneath raised floors. Afterwards, the tiles can simply be put back in place.

Our score:

Up to 1 credit Functional adaptability

SPECULATIVE FINISHES

→ WST.04

A mock-up or simulation helps to make the right choice in advance. The 3D simulator on the 2TEC2 website turns ideas into concrete results. We guide and support the end user in making the right choice to prevent unnecessary waste.

Our score:

Up to 1 credit Speculative finish



Management and re-use of construction- and industrial waste

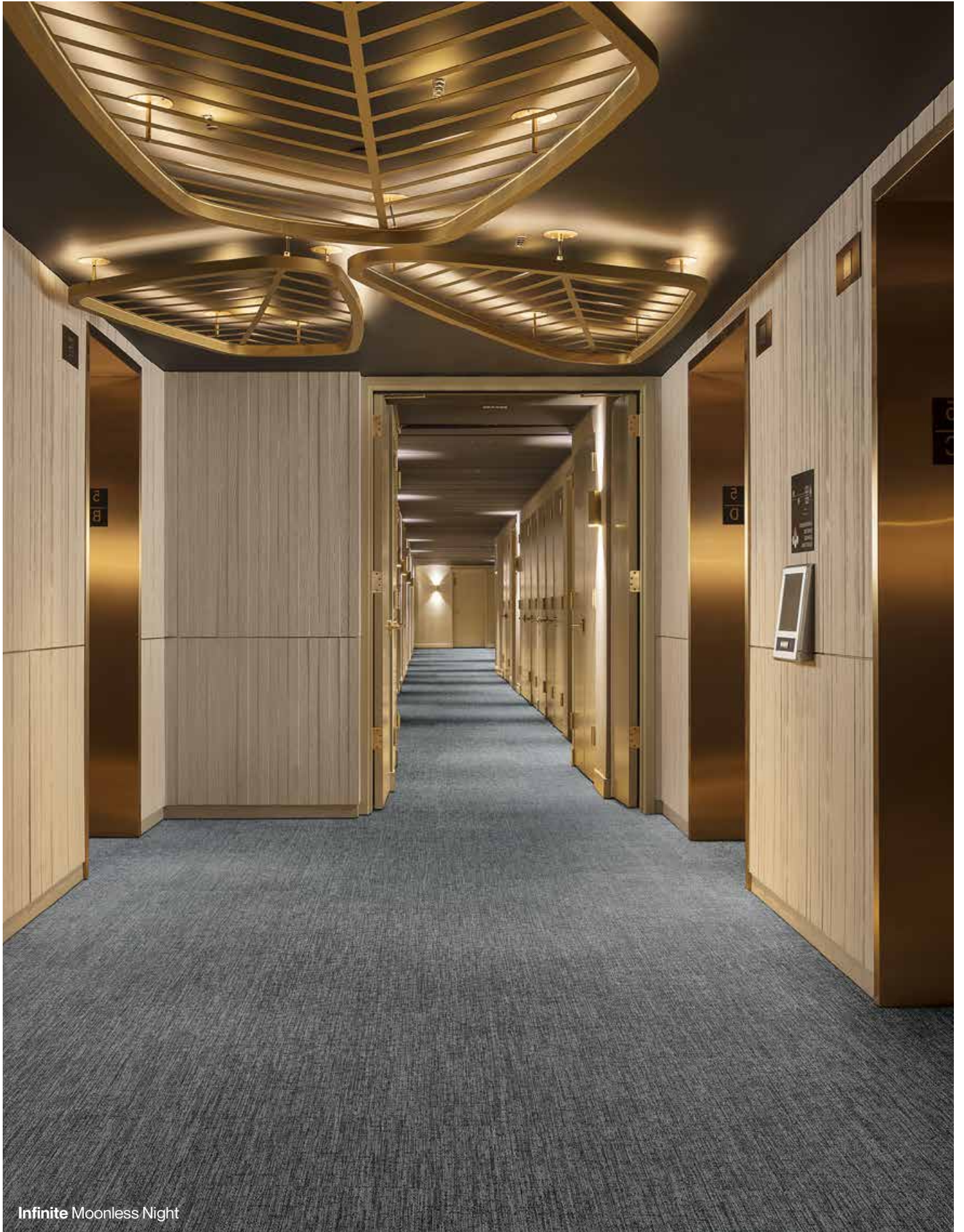

REFINED WOVEN FLOORING

2TEC2 is a high-tech woven floor covering. The woven top layer provides the a refined 3D structure and is waterproof.

The backing consists of felt made from recycled PET and provides excellent acoustic properties and walking comfort.

2TEC2 offers a wide range of designs, colours and shapes.

Product cross-section:

- 01 Woven layer
- 02 Precoat layer
- 03 Fibreglass non-woven layer
- 04 Base coat layer
- 05 Acoustic felt layer SonoFelt™

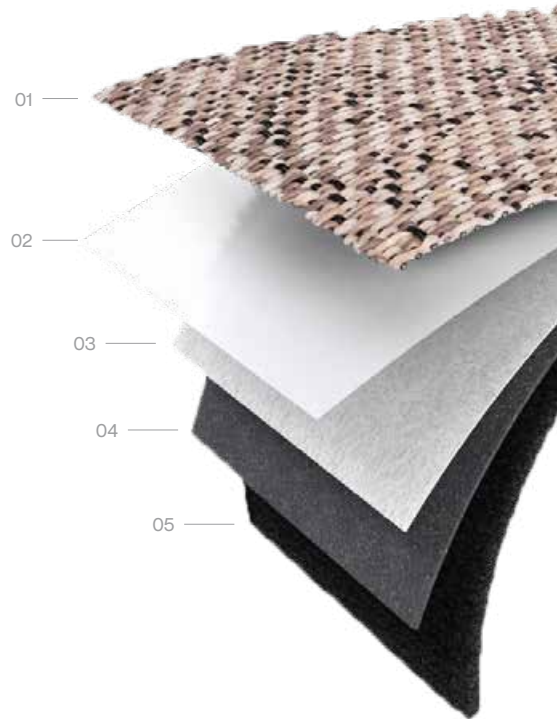





2tec2[®]
high tech flooring

Headquarters & showroom
Chaussée d'Aelbeke 284 - 7700 Mouscron, Belgium
+32 56 85 47 47 - sales@2tec2.com

WWW.2TEC2.COM